

# Sea Ray

'76







### **Outstanding Quality in Fiberglass Boats.**

We at Sea Ray Boats are proud to present to you our 1976 line of high quality fiberglass boats. This is our seventeenth year of production, and when we introduced the first Sea Ray back in 1959 it was never our intention to be the biggest boat manufacturer—just the best.

This policy has served as our doctrine, and although we have become one of the largest pleasure boat builders in the world, we have never sacrificed our dedication to being the very best. In the construction of each Sea Ray Boat we use the finest materials available. Our strong, rugged hull construction is second to none and provides exceptional seaworthiness

and a solid, smooth ride. Thump the side of a Sea Ray hull and compare the solid feel against that of other brands of fiberglass boats.

All Sea Ray Boats comply with standards set by the United States Coast Guard and have been inspected for compliance with the safety standards set by the Boating Industry Association.

In addition to BIA certification, Sea Rays are designed and engineered in accordance with numerous other BIA and American Boat and Yacht Council recommended practices.

Sea Ray Boats are produced in three modern boat

building facilities and are distributed to dealers throughout the United States, Europe, South America and Asia. We are just as proud of our dealer organization as we are of the design and construction of the boats themselves. Before receiving a Sea Ray franchise, each dealer must be able to show superior qualifications in business management, facilities, customer service and boating leadership in his community. This selective policy has resulted in better boating enjoyment for you—the Sea Ray owner.

We invite you to inspect the 1976 Sea Ray line on the following pages. It's our best ever. Then visit your local Sea Ray dealer and let him help you select the model that's just right for your needs.



OXFORD, MICHIGAN is our original home dating back to 1959. This plant has grown to become one of the largest and most modern fiberglass boat factories in the world, serving Sea Ray customers throughout the Midwest, East, and South



PHOENIX, ARIZONA is the location of our Western manufacturing facility. We began operations here in 1968, and in the spring of 1971 expanded into a brand new factory designed specifically for boat manufacturing.



MERRITT ISLAND, FLORIDA is Sea Ray's newest site and the factory in which all 300 Series Sea Rays are manufactured. Also housed here is our design and development department; the mild climate and our waterfront facilities affording year-round testing capability.



# SRV 300

## Sedan & Sedan Bridge

### Specifications:

Gunwale Length .....	30' 11"
Centerline Length .....	29' 7"
Beam .....	11' 6"
Transom Width at	
Gunwale .....	11' 0"
Transom Width at Chine ..	9' 7"
Draft (Twin Engines) ...	29"
Approximate Weight:	
Sedan .....	10,400 lb.
Sedan Bridge .....	10,800 lb.

### Features and Standard

#### Equipment

#### Hull

Stainless Steel Bow & Stern Eyes  
Stainless Steel Bow Rail—Welded  
Teak Swim Platform  
Saltwater Hardware  
Tri-section Safety Glass Tinted  
Windshield  
Sliding Side Windows  
Anodized Solid Aluminum Rub Rail  
International Rule Navigation  
Lights

### Cabin

Forward V-Bunk  
Convertible Sofa & Chair  
Galley:  
Two-Burner Alcohol Stove  
Sink  
3.5 Cubic Foot Ice Box  
Glass and Dish Storage Racks  
Separate Fiberglass Shower/  
Toilet Stall  
Marine Head  
Vanity with Stainless Steel Sink  
Liquor Cabinet  
Cabin Windows  
Translucent Cabin Hatches  
Hanging Locker  
Forward Anchor Rope Locker  
Cabin Side Storage Shelves  
Full-Length Mirror  
Deep Pile Shag Carpet  
Sedan Enclosure with Sliding  
Glass Door

### Cockpit

Self-Bailing Teak Plank Deck  
Cockpit Side Storage Shelves  
Indirect Cockpit Lighting

### Power Options

Single 350 H.P. Inboard  
Twin Inboards from 233 H.P. to  
260 H.P.

### Systems

130-Gallon Fuel Capacity (two  
aluminum plate tanks)  
Anti-Siphon Valves  
40-Gallon Fresh Water Supply  
Pressure Water System  
12-Volt Electrical System with  
Fused Panel  
Dual Lever Binnacle Control  
Automatic Bilge Pump  
Two Electric Bilge Blowers  
12 V Cabin Courtesy Lights  
Bonding System Minimizes  
Electrolysis

### Sedan Bridge Only

Bimini Top  
Venturi Bridge Shield  
Stainless Steel Bridge Access  
Ladder—Welded  
Bridge Captain's Chair  
Bridge Companion Seats  
Full Bridge Controls and  
Instrumentation  
Lower Station Controls Optional)  
12 V Fused Switch Panel

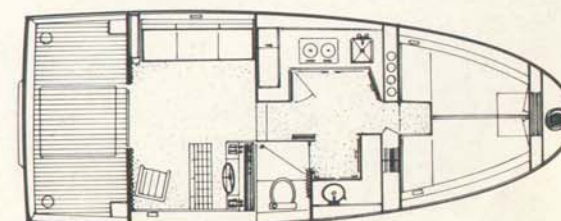
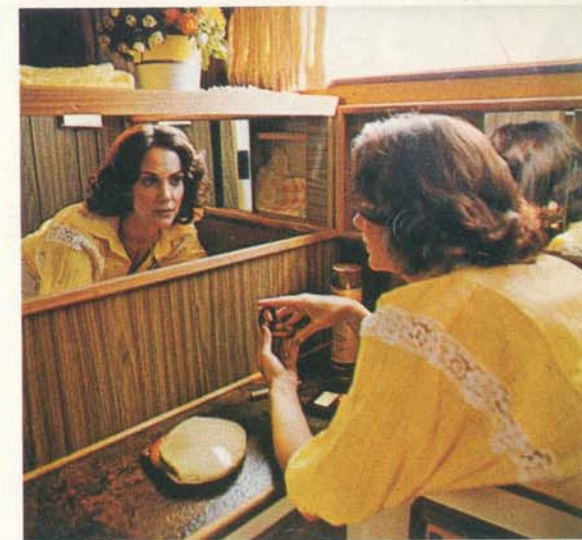





# SRV 300

## Weekender, Hardtop, Sportbridge

### Specifications:

Gunwale Length .....	30' 11"
Centerline Length .....	29' 7"
Beam .....	11' 6"
Transom Width at Gunwale .....	11' 0"
Transom Width at Chine ..	9' 7"
Cockpit Length .....	12' 0"
Draft (Twin Engines) ....	29"
Approximate Weight:	
Weekender .....	9000 lb.
Hardtop .....	9400 lb.
Sportbridge .....	9800 lb.

### Features and Standard Equipment

#### Hull

Stainless Steel Bow & Stern Eyes  
 Stainless Steel Bow Rail—Welded  
 Teak Swim Platform  
 Saltwater Hardware  
 Vented, Anodized Aluminum Skiff  
 Windshield  
 Sliding Side Windows (Hardtop  
 & Sportbridge)  
 Anodized Solid Aluminum Rub  
 Rail  
 International Rule Navigation  
 Lights  
 Soft Top and Boot (Weekender)  
 Bimini Top (Sportbridge)





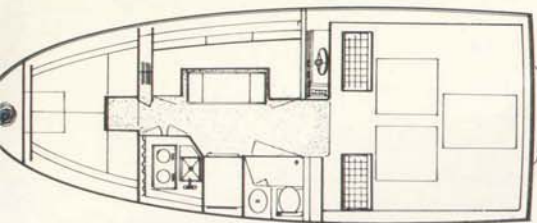

### Cabin

Forward V-Bunk  
Convertible Dinette with Dining-Coffee Table  
Galley:  
Two-Burner Alcohol Stove  
Sink  
3.5 Cubic Foot Ice Box  
Glass and Dish Storage Racks  
Stand-up Enclosed Marine Head  
Fiberglass Vanity with Sink  
Liquor Cabinet  
Cabin Windows  
Translucent Mid-Cabin & Forward Hatches  
Hanging Locker  
Forward Anchor Rope Locker  
Cabin Side Storage Shelves  
Full-Length Mirror  
Deep Pile Shag Carpet

### Cockpit

Self-Bailing Fiberglass Cockpit Deck  
Double Helmsman Seat  
Double Companion Seat  
Cockpit Side Storage Shelves  
Indirect Cockpit Lighting  
Teak Drink Holders

### Power Options

Single 350 H.P. Inboard  
Twin Inboards from 233 H.P. to 350 H.P.  
Twin Stern Drives from 188 H.P. to 280 H.P.

### Systems

130-Gallon Fuel Capacity (two aluminum plate tanks)  
Anti-Siphon Valves  
40-Gallon Fresh Water Supply  
Pressure Water System  
12-Volt Electric System with Fused Panel  
Dual Lever Binnacle Control  
Automatic Bilge Pump  
Two Electric Bilge Blowers  
12 V Cabin Courtesy Lights  
Bonding System Minimizes Electrolysis



### Sportbridge Only

Venturi Bridge Shield  
Stainless Steel Bridge Access Ladder—Welded  
Adjustable Bridge Captain's Seat  
Bridge Lounge Seats  
Full Bridge Controls and Instrumentation  
12 V Fused Switch Panel





# SRV 240

## Sundancer

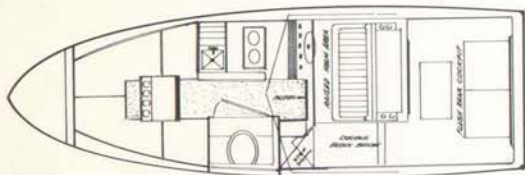

**Specifications:**  
 Gunwale Length ..... 25' 8"  
 Centerline Length ..... 24' 4"  
 Beam ..... 96"  
 Transom Width ..... 92"  
 Fuel Capacity ..... 70 ga.  
 Approximate Weight .... 4500 lb.

### Standard Features:

Foam Flotation  
 Stainless Steel Bow & Stern Eyes  
 Stainless Steel Bow Rail  
 Teak Taff Rail  
 Teak Full Transom Swim Platform  
 International Rule Navigation Lights  
 Forward Anchor Locker  
 Custom Deck Ventilators  
 Tinted Plexiglass Venturi Shield  
 Cabin Hull Windows  
 Electric Bilge Pump & Blower

### Standard Cabin Features:

Full Stand-up Head Room  
 Translucent Cabin Deck Hatch  
 Polypropylene Carpeting  
 Side Shelf Storage  
 Indirect Lighting  
 Stand-up Enclosed Head with  
 Monogram Sanitary System  
 V-Bunk  
 Full-Size Aft Cabin Bunk  
 V-Bunk Dinette Table  
 Complete Galley Featuring:  
 Alcohol Stove Ice Box  
 Sink & Electric Water System

### Standard Cockpit Features:

Non-Skid Fiberglass Floor  
 Self-Bailing, Flush Deck  
 Side Panel Storage  
 Floor Storage  
 Indirect Lighting  
 Double Width Helm Seat with  
 Fold-Down Aft Facing Companion Seat  
 Removable Fish Box Aft Seat  
 Custom Dash with Recessed  
 Instrumentation  
 Plexiglass Instrument Shield  
 Custom Fused Switch Panel  
 Single Lever Binnacle Control

### Factory Installed Options:

Bimini Sport Top & Boot  
 Front & Side Curtains Aft Curtain  
 Mooring Cover Helm Cover  
 Taff Rail Curtain  
 Alcohol/Electric Stove  
 110 V/12 V Refrigerator  
 110 V/115 V Dockside Power  
 Electric Horn  
 Dash Controlled Spotlight  
 Compass  
 Hour Meter





# SRV 240 Weekender

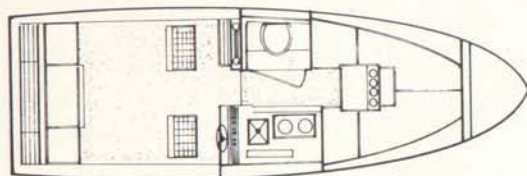

## Specifications:

Gunwale Length ..... 25' 8"  
Centerline Length ..... 24' 4"  
Beam ..... 96"  
Transom Width ..... 92"  
Fuel Capacity ..... 70 ga.  
Approximate Weight .... 4400 lb.

## Standard Features:

Foam Flotation  
Stainless Steel Bow & Stern Eyes  
Stainless Steel Bow Rail  
Teak Taff Rail  
Teak Full Transom Swim Platform  
International Rule Navigation  
Lights  
Forward Anchor Locker  
Custom Deck Ventilators  
Safety Glass, Full Vent Windshield  
Cabin Hull Windows  
Convertible Top  
Electric Bilge Pump & Blower

## Standard Cabin Features:

Full Stand-up Head Room  
Translucent Cabin Deck Hatch  
Polypropylene Carpeting  
Side Shelf Storage  
Indirect Lighting  
Stand-up Enclosed Head with  
Monogram Sanitary System  
V-Bunk  
V-Bunk Dinette Table  
Complete Galley Featuring:  
Alcohol Stove  
Ice Box  
Sink & Electric Water System

## Standard Cockpit Features:

Polypropylene Carpeting  
Insulated Motor Box  
Side Panel Storage  
Floor Storage  
Insulated Ice Chests in Aft Deck  
Indirect Lighting

Two Adjustable Helmsman Seats  
Aft Jump Seats Convertible  
to Bunk  
Custom Dash with Recessed  
Instrumentation  
Custom Fused Switch Panel  
Single Lever Binnacle Control

## Factory Installed Options:

Top Boot  
Side & Aft Curtains  
Camper Aft Cover  
Mooring Cover  
Alcohol/Electric Stove  
110 V/12 V Refrigerator  
110 V/115 V Dockside Power  
Electric Horn  
Dash Controlled Spotlight  
Windshield Wipers  
Compass  
Hour Meter







## SRV 240 Cuddy Cabin Sport Bridge and Hardtop

### Specifications:

Gunwale Length .....	25' 8"
Centerline Length .....	24' 4"
Beam .....	96"
Transom Width .....	92"
Fuel Capacity .....	70 ga.
Approximate Weight:	
Cuddy Cabin .....	3900 lb.
Hardtop .....	4200 lb.
Sportbridge .....	4400 lb.

### Standard Features:

Foam Flotation  
 Stainless Steel Bow & Stern Eyes  
 Stainless Steel Bow Rail  
 Teak Taff Rail  
 Teak Full Transom Swim Platform  
 International Rule Navigation Lights  
 Cabin Deck Hatch  
 Forward Anchor Locker  
 Custom Deck Ventilators  
 Fiberglass Nonskid Cockpit Deck  
 Insulated Motor Box  
 Cockpit Side Panel Storage  
 Cabin Side Shelf Storage  
 Insulated Ice Chests in Aft Deck  
 Indirect Cockpit & Cabin Lights





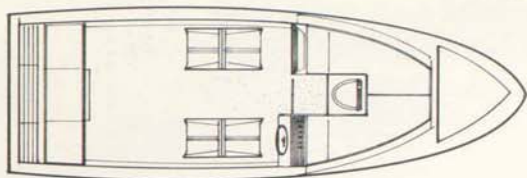

Adjustable Helmsman Seats  
Aft Jump Seats Convertible into Bunk  
Cabin V-Bunk  
Safety-Glass Venting Windshield  
Tinted Venturi Windshield (SB)  
Sliding Side Windows (HT, SB)  
Cabin Hull Windows  
Convertible Top (CC)  
Electric Bilge Pump & Blower  
Heavy Duty Steering  
Custom Dash with Recessed Instrumentation  
Custom Fused Switch Panel  
Single Lever Binnacle Control  
Dual Control Stations (SB)

#### **Factory Installed Options**

Marine Head  
Porta-Potti  
Monogram Sanitary System  
Back-to-Back Lounge Seats  
Lounge seat foot rest  
Convertible Dinette and Galley with Sink, Ice Box,  
Alcohol Stove  
Sedan Enclosure (HT, SB)  
Alcohol Electric Stove  
110 V/12 V Refrigerator  
110 V/115 V Dockside Power  
Top Boot (CC, SB)  
Bimini Sport Top (SB)  
Side Curtains (CC)  
Aft Curtain (CC, HT, SB)  
Camper Aft Cover (CC, HT, SB)  
Sport Bridge Cover (SB)  
Electric Horn  
Dash Controlled Spotlight  
Windshield Wipers  
Hour Meter  
Compass





# SRV 220

## Cuddy Cabin & Hardtop

### Specifications:

Gunwale Length .....	23' 0"
Centerline Length .....	21' 7"
Beam .....	96"
Transom Width .....	91"
Fuel Capacity:	
Cuddy Cabin .....	70 ga.
Hardtop .....	50 ga.
Approximate Weight:	
Cuddy Cabin .....	3400 lb.
Hardtop .....	3600 lb.

### Standard Features:

Foam Flotation  
 Stainless Steel Bow & Stern Eyes  
 Stainless Steel Bow Rail    Teak Taff Rail  
 Teak Swim Platform with Boarding Ladder  
 Inland Rule Navigation Lights (Cuddy Cabin)  
 International Rule Navigation Lights (Hardtop)  
 Cabin Deck Hatch    Forward Anchor Locker  
 Custom Deck Ventilators  
 Polypropylene Carpeting  
 Insulated Motor Box  
 Cockpit Side Panel Storage    Cabin Side Shelf Storage  
 Insulated Ice Chests in Aft Deck  
 Indirect Cabin & Cockpit Lighting  
 Back-to-Back Lounge Seating  
 Aft Jump Seats Convertible to Bunk    Cabin V-Bunk  
 Safety Glass Walk-thru Windshield  
 Sliding Side Windows (Hardtop)  
 Convertible Top (Cuddy Cabin)  
 Electric Bilge Pump & Blower  
 Heavy Duty Steering  
 Custom Dash with Recessed Instrumentation  
 Custom Fused Switch Panel  
 Single Lever Panel Control

### Factory Installed Options:

Full Transom Swim Platform  
 Marine Head    Porta-Potti  
 Monogram Sanitary System  
 Galley & Convertible Dinette  
 Alcohol/Electric Stove  
 110 V/12 V Refrigerator  
 110 V/115 V Dockside Power  
 Cabin Side Windows  
 Top Boot (Cuddy Cabin)  
 Side Curtains (Cuddy Cabin)    Aft Curtain  
 Camper Aft Cover  
 Mooring Cover (Cuddy Cabin)  
 Electric Horn  
 Dash Controlled Spotlight  
 Windshield Wiper  
 Hour Meter

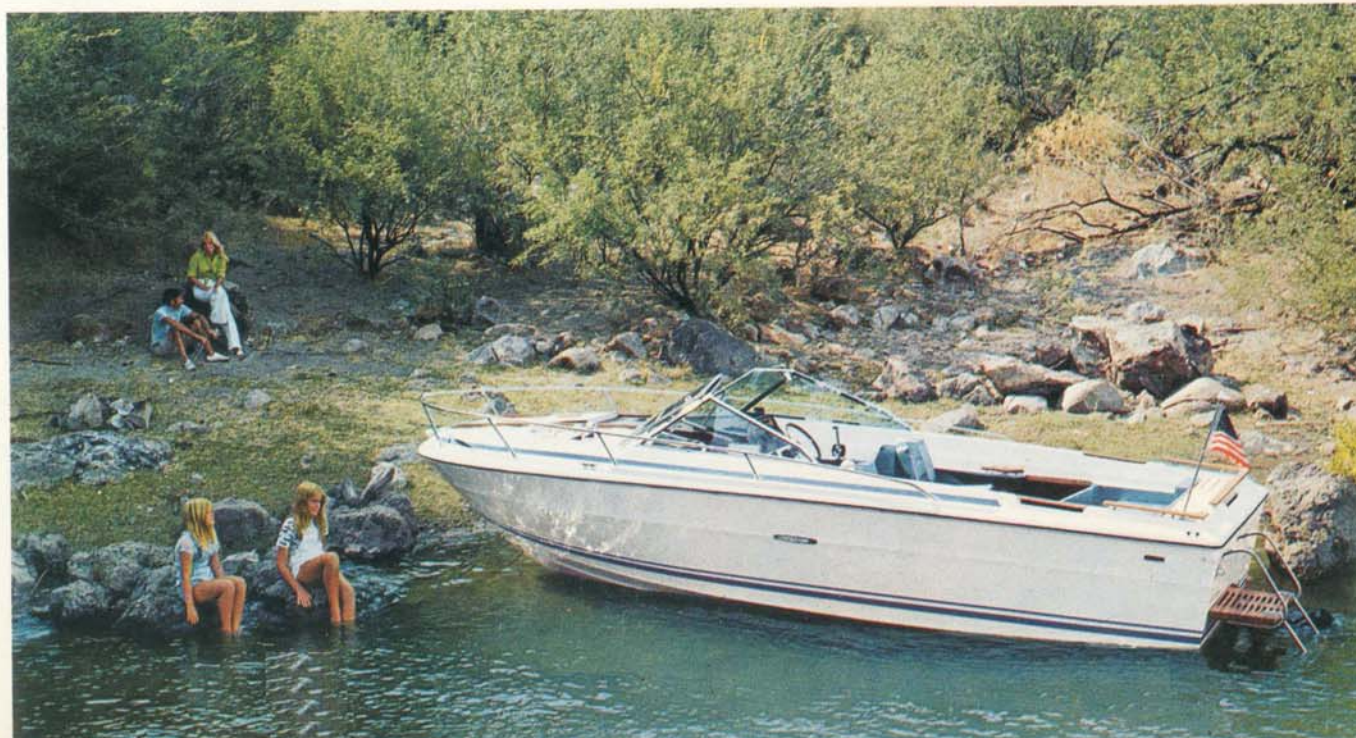
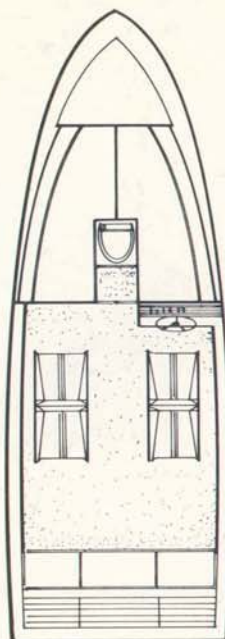



# SRV 220

## Overnighter

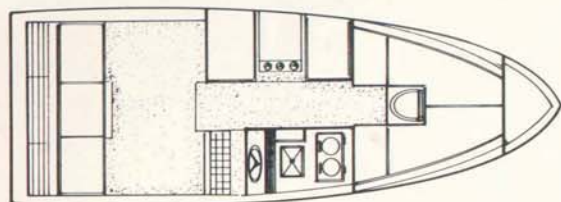

### Specifications:

Gunwale Length .....	23' 0"
Centerline Length .....	21' 7"
Beam .....	96"
Transom Width .....	91"
Fuel Capacity .....	60 ga.
Approximate Weight .....	3600 lb

### Standard Features:

- Foam Flotation
- Stainless Steel Bow & Stern Eyes
- Stainless Steel Bow Rail
- Teak Taff Rail
- Teak Swim Platform with Boarding Ladder
- International Rule Navigation Lights
- Cabin Deck Hatch
- Forward Anchor Locker
- Custom Deck Ventilators
- Polypropylene Carpeting
- Insulated Motor Box
- Cockpit Side Panel Storage
- Cabin Side Shelf Storage
- Insulated Ice Chests in Aft Deck
- Indirect Cockpit & Cabin Lighting
- Adjustable Helm Seat
- Aft Jump Seats Convertible to Bunk
- Cabin V-Bunk
- Convertible Dinette
- Galley with Sink, Ice Box & Stove
- Electric Water System
- Safety Glass Windshield with
  - Forward Cabin Vent &
  - Sliding Side Windows
- Custom Fiberglass Hardtop
- Electric Bilge Pump & Blower
- Heavy Duty Steering
- Custom Dash with Recessed Instrumentation
- Custom Fused Switch Panel
- Single Lever Binnacle Control

### Factory Installed Options:

- Alcohol/Electric Stove
- 110 V/12 V Refrigerator
- 110 V/115 V Dockside Power
- Side & Aft Curtains
- Camper Aft Cover
- Full Transom Swim Platform
- Cabin Side Windows
- Marine Head
- Porta-Potti
- Monogram Sanitary System
- Electric Horn
- Dash Controlled Spotlight
- Windshield Wipers
- Hour Meter





# SRV 200

## Specifications:

Gunwale Length ..... 21' 2"  
 Centerline Length ..... 19' 11"  
 Beam ..... 96"  
 Transom Width ..... 90"  
 Fuel Capacity ..... 30 ga.  
 Approximate Weight .... 2900 lb.

## Standard Features:

Foam Flotation  
 Stainless Steel Bow & Stern Eyes  
 Stainless Steel Bow Rail  
 Teak Taff Rail  
 Teak Swim Platform with  
 Boarding Ladder  
 Running Lights  
 Bow Hatch & Anchor Locker  
 Custom Deck Ventilators  
 Polypropelene Carpeting  
 Insulated Engine Compartment  
 Side Storage Panels  
 Floor Storage

Locking Glove Box Storage  
 Insulated Floor Cooler  
 Indirect Cockpit Lights  
 Teak Drink Holders  
 Back-to-Back Lounge Seats  
 Aft Jump Seats  
 Insulated Cooler Under Aft Seat  
 Walk-thru Safety Glass  
 Windshield  
 Convertible Top  
 Electric Bilge Pump & Blower  
 Heavy Duty Steering  
 Single Lever Panel Control

Custom Dash with Recessed  
 Instrumentation  
 Custom Fused Switch Panel

## Factory Installed Options:

Top Boot  
 Side & Aft Curtains  
 Camper Aft Cover  
 Mooring Cover  
 Full Transom Swim Platform  
 Electric Horn  
 Windshield Wipers  
 Dash Controlled Spotlight  
 Hour Meter





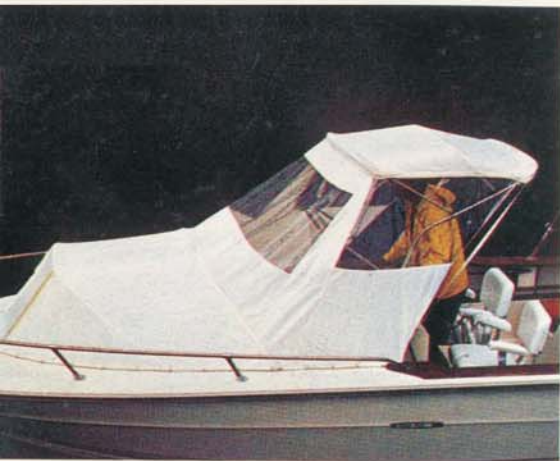

# SRV 200

## Amberjack

### Specifications:

Gunwale Length .....21' 2"  
 Centerline Length .....19' 11"  
 Beam ..... 96"  
 Maximum Outboard H.P. ... 200  
 Fuel Capacity .....55 ga.  
 Approximate Weight:  
   Outboard .....2100 lb.  
   Sterndrive .....3150 lb.

### Standard Features:

Foam Flotation  
 Stainless Steel Bow & Stern Eyes  
 Stainless Steel Bow Rail  
 Running Lights  
 Forward Anchor Locker  
 Fiberglass Nonskid Self-Bailing  
 Cockpit  
 Teak Rod Storage Racks  
 Floor Storage  
 Center Console with Locking  
 Storage  
 Plexiglass Windbreak Shield  
 Plexiglass Instrument Shield  
 Storage beneath Casting Platform  
 Upholstered Seat Forward of  
 Console with Fish Box  
 Underneath

Upholstered Helm Seat with  
 Two Way Back Rest and Fish  
 Box Underneath  
 Heavy Duty Mechanical Steering

### Additional Features on

#### Sterndrive Models:

Teak Swim Platform with  
 Boarding Ladder  
 Custom Deck Ventilators  
 Insulated Motor Box  
 Single Lever Binnacle Control  
 Electric Bilge Pump & Blower  
 Custom Fused Switch Panel

### Factory Installed Options:

Bimini Sport Top & Boot  
 Front & Side Curtains  
 Spray Hood & Boot  
 Helm Cover  
 Full Transom Swim Platform  
 (Sterndrive Models)  
 Swivel Pedestal Helm Seats  
 Electric Horn  
 Hour Meter (Sterndrive Models)

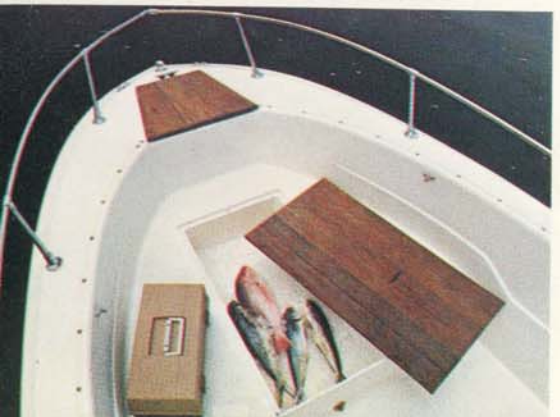





# SRV 195

## Specifications:

Gunwale Length .....19' 10"  
Centerline Length .....18' 6"  
Beam ..... 96"  
Transom Width ..... 89"  
Fuel Capacity ..... 30 ga.  
Approximate Weight ....2800 lb.

## Standard Features:

Foam Flotation  
Stainless Steel Bow & Stern Eyes  
Stainless Steel Bow Rail  
Teak Taff Rail  
Teak Swim Platform with  
Boarding Ladder  
Running Lights  
Bow Hatch & Anchor Locker  
Custom Deck Ventilators  
Polypropylene Carpeting  
Insulated Engine Compartment

Side Storage Panels  
Floor Storage  
Locking Glove Box Storage  
Insulated Floor Cooler  
Indirect Cockpit Lights  
Teak Drink Holders  
Back-to-Back Lounge Seats  
Aft Jump Seats  
Insulated Cooler Under Aft Seat  
Walk-thru Safety Glass Windshield  
Convertible Top  
Electric Bilge Pump & Blower  
Heavy Duty Steering  
Single Lever Panel Control  
Custom Dash with Recessed  
Instrumentation  
Custom Fused Switch Panel

## Factory Installed Options:

Top Boot  
Side & Aft Curtains  
Mooring Cover  
Full Transom Swim Platform  
Electric Horn  
Windshield Wipers  
Dash Controlled Spotlight  
Hour Meter





# SRV 190

## Specifications:

Gunwale Length	19' 4"
Centerline Length	18' 1"
Beam	89"
Transom Width	84"
Maximum Outboard H.P.	150
Fuel Capacity:	
Outboard	18 ga.
Sterndrive	30 ga.
Approximate Weight:	
Outboard	1500 lb.
Sterndrive	2600 lb.

## Standard Features:

Foam Flotation  
Stainless Steel Bow & Stern Eyes  
Stainless Steel Bow Rail  
Running Lights  
Polypropylene Carpeting  
Side Panel Storage Floor Storage  
Center Console with Locking Storage Compartment  
Back-to-Back Lounge Seats  
Aft Jump Seats  
Insulated Cooler Under Aft Seat  
Safety Glass Walk-thru Windshield  
Heavy Duty Mechanical Steering  
Custom Dash with  
    Recessed Instrumentation

## Additional Features on Sterndrive Models

Teak Taff Rail  
Teak Swim Platform with  
    Boarding Ladder  
Custom Deck Ventilators  
Insulated Engine Compartment  
Indirect Cockpit Lighting  
Convertible Top  
Electric Bilge Pump & Blower  
Single Lever Panel Control  
Custom Fused Switch Panel

## Factory Installed Options:

Convertible Top  
    (Outboard Models)  
Top Boot  
Side & Aft Curtains  
Mooring Cover  
Full Transom Swim Platform (Sterndrive Models)  
Electric Horn  
Windshield Wipers  
Dash Controlled Spotlight  
Hour Meter (Sterndrive Models)







## SRV 193

### Specifications:

Gunwale Length ..... 20' 0"  
Centerline Length ..... 18' 2"  
Beam ..... 89"  
Fuel Capacity ..... 24 ga.  
Approximate Weight ..... 2750 lb.

### Standard Features:

Foam Flotation  
Stainless Steel Bow Rail  
Teak Taff Rail  
Teak Swim Platform with  
Boarding Ladder  
Custom Deck Ventilators  
Polypropylene Carpeting  
Side Panel Storage Floor Storage  
Two Insulated Ice Chests  
Back-to-Back Lounge Seats  
Aft Jump Seats  
Safety Glass Walk-thru Windshield  
Convertible Top  
Bilge Pump & Blower  
Custom Dash with Full  
Instrumentation



## SRV 180

### Specifications:

Gunwale Length ..... 17' 8"  
Centerline Length ..... 16' 7"  
Beam ..... 83"  
Maximum H.P.—Outboard... 120  
Fuel Capacity ..... 18 ga.  
Approximate Weight:  
Sterndrive Model ..... 2300 lb.  
Outboard Model ..... 1350 lb.

### Standard Features:

Foam Flotation  
Stainless Steel Bow Rail  
Polypropylene Carpeting  
Side Panel Storage Floor Storage  
Locking Console Storage  
Insulated Ice Chest  
Back-to-Back Lounge Seats  
Aft Jump Seats  
Walk-thru Safety Glass Windshield  
Convertible Top (I/O only)  
Custom Dash with Recessed  
Instrumentation

For a period of one year from the date of delivery to the original retail purchaser, SEA RAY BOATS warrants each SEA RAY BOAT to be free from defects caused by faulty workmanship or materials.

During this period, warranty repairs will be made without charge by SEA RAY BOATS at one of their manufacturing plants, or at SEA RAY's option, by an authorized SEA RAY dealer at the dealer's store or service center. Transportation costs to the SEA RAY manufacturing plant or to the authorized SEA RAY dealer's service center are the responsibility of the purchaser. All warranty repairs must be approved by an authorized SEA RAY representative.

Engines, outdrives, propellers and controls are covered by the warranties of the manufacturers supplying these units, and not by the provisions of this warranty.

This warranty does not cover used boats, windshield breakage, gelcoat or upholstery damage, or boats or parts which have been altered or subjected to misuse or negligence.

The obligation of SEA RAY BOATS under this warranty shall be limited to the repair or replacement of any part which is judged defective by SEA RAY BOATS. SEA RAY BOATS WILL NOT BE LIABLE FOR HAUL OUT, LAUNCH, TOWING OR STORAGE CHARGES, INCONVENIENCE OR LOSS OF TIME OR INCOME, OR ANY OTHER SPECIAL OR CONSEQUENTIAL DAMAGES OF ANY KIND OR NATURE. IMPLIED WARRANTIES, IF ANY, SHALL BE LIMITED TO THE DURATION OF THIS WRITTEN LIMITED WARRANTY.

The information contained in this literature is based upon the latest product information available at the time of publication approval. Sea Ray Boats reserves the right to make changes at any time, without notice in the colors, equipment, specifications, materials, hulls and prices—and also, to discontinue models. When changes are made, we reserve the right to do so without incurring the obligations to equip or modify existing models built prior to the date of such changes.



OXFORD, MICHIGAN  
PHOENIX, ARIZONA  
MERRITT ISLAND, FLORIDA