



OVERALL LENGTH
W/STANDARD
SWIM PLATFORM

32' 3"
9.82 M

OVERALL LENGTH W/OPTIONAL
EXTENDED HYDRAULIC
SWIM PLATFORM

34' 3"
10.44 M



Arctic White



Horizon



Sea Ray Blue



Mojave Tan



Onyx

BEAM	10'8" / 3.25 M
DRY WEIGHT	13,305 LB / 6035 KG
DRAFT (STERNDIVES DOWN & UP)	TBD
DEADRISE	21°
HOLDING TANK	28 GAL / 106 L

The specification measurements are approximations and subject to variance.



170 GAL
643 L



32 GAL
121 L



4
PEOPLE

SUNDANCER 320 FEATURES

- Robust bow lounging & seating area with actuated headrests and armrests allow for perfect comfort while underway or at rest.
- The cockpit features a reversible helm companion seat that converts to face aft, a well-equipped standard wetbar with sink and storage, and offers a refrigerator and grill as options.
- An optional transom Sungate opens directly onto the swim platform, providing uninterrupted water access.
- A deluxe head, gourmet-ready galley with extending countertops, flatscreen TV and generous storage are features of a beautifully designed cabin with sleeping accommodations for 4.
- Available hardtop w/ open windshield

STANDARD PROPULSION

Twin MerCruiser® 4.5L MPI ECT
Bravo® III Sterndrives w/DTS
(T-250 hp - 186 kW)

Sea Ray
LAUNCH INTO LIVING

SUNDANCER® 320

FEATURES & STANDARD EQUIPMENT

HULL & DECK FEATURES

Anchor Chute, Stainless Steel w/Hatch
Anchor, Galvanized
Bottom Paint
Bow & Stern Eyes, Stainless Steel
Bow Rail, Stainless Steel w/Welded Stanchions
Cleats, 10" Thru-Bolted, Stainless Steel, w/Sea Ray Logo (8)
Deck Fill Plates, Stainless Steel
Drain Plug, Brass-Threaded - Garboard
Gel Coat, Arctic White
Graphics, Striping
Handrails, Stainless Steel
Horn, Stainless Steel
Hull Windows, Large Acrylic
Light, Stern
Lights, Navigation - Stainless Steel
Rub Rail, PVC w/Stainless Steel Insert
Ski Eye - Transom
Storage, Bow
Storage, Transom Wall - For Dock Lines, Fenders & Gear
Swim Platform, Integral w/Undermount Stainless Steel
Four-Step Swim Ladder
Thru-Hull Fittings, Stainless Steel
Vent System, Integral - Engine Room
Windshield, Tempered / Tinted Glass w/Stainless Steel
Supports and Port Side Walk-Thru Door
Windshield Wiper - Starboard

TOWERS & CANVAS:

Bimini Arch w/ Canvas
Canvas Package: Includes Aft Curtain w/ Bungee Straps,
Front & Side Curtains, Canvas Storage Bag & Tonneau
Cover

CERTIFICATIONS:

Meets Applicable USCG & ABYC Standards
NMMA Certification
Mercury® Installation Quality Certification

COCKPIT FEATURES

Beverage Holders, Stainless Steel
Carpet Liner, Snap-In
Cockpit Color Package: Ivory (White) or Dune (Tan)
Cooler, Carry-On w/Designated Storage
Door, Transom, Acrylic w/ Stainless Steel Hardware
Floor Liner, Fiberglass - Self-Bailing
Hatch, Engine Room - Electrically Actuated w/ Emergency
Pull Handle & Prop Rod
Lighting, Indirect LED
Outlet, 12V Accessory - Helm & Bow
Outlet, 120V GFI Protected
Seating, Aft Bench, w/ Built-In Table Storage
Seating, Bow, w/ Fold-Down Arm Rests & Adjustable Head
Rests

Seating, Port Helm Bench with Convertible Backrest; Dual
Helm Seat on Starboard with Flip-Up Thigh Rise
Steps, Boarding - Molded-In
Storage, Side Panel Tubs
Storage, Transom Wall
Table, Fiberglass, w/Dedicated Storage
Wet Bar w/Solid Surface, Stainless Steel Sink, Hot & Cold
Faucet, Slide-Out Trash Can & Stainless Steel Handrail

CABIN FEATURES

Carbon Monoxide Monitor
Carpet, Deep-Pile BCF - 44-Ounce, 100% Nylon
Door, Cabin Entry, Sliding & Lockable
Lighting, 12V
Outlet, 12V Accessory
Outlets, 120V GFI Protected
Pillows, Accent
Shades, Pleated - Hull Windows
Steps, Cabin Entry - Aluminum Frame w/ Teak Treads
Stereo, 12V AM/FM, Wireless Bluetooth™, MP3 Port,
Speakers (2 Cabin, 4 Cockpit) & Digital Remote Control &
Speaker Selector Switches
Storage - In-Floor
Storage Cabinets & Lockers w/ Shelves
Wood Interior Package - Driftwood (Std) or Prestige Cherry
Finished Cabinetry

GALLEY:

Countertop - Solid Surface
Microwave
Refrigerator, Dual-Voltage
Shelf, Slide-Out
Storage, Lower Cabinetry

HEAD:

Bathroom Tissue Holder
Door, Privacy
Handrail, Stainless Steel
Head (VacuFlush®)
Head, Enclosed - Full Fiberglass w/Shower & Curtain
Mirror, Head Door - Full Length
Power Vent, 12V
Storage, Medicine Cabinet w/Mirrored Doors
Vanity w/Solid Surface Countertop, Vessel Sink, Single Lever
Faucet w/ Shower Wand, & Storage Below

MID-BERTH:

Bunks, Twin (2) w/Mattresses, Pillows, Sheets &
Coordinated Spread, Slides to Convert into King-Size
Berth
Curtains, Privacy
Storage Under Berths

V-BERTH:

Opposing Seating - Converts to Sleeper w/ Mattress &
Storage Below
Table, Dinette - Solid Wood

TECHNICAL FEATURES

HELM:

Alarm, High-Water
Horn Switch
Instrument Panels
Parallel Start System - Engines
SmartCraft® Digital Throttle & Shifts (DTS)
SmartCraft Diagnostics:

- Instrumentation, Custom Sea Ray® SmartCraft 4-in-1
Multi-gauges (2) w/Glass Lenses, Low-Glare Blue
Night Lighting & Chrome Bezels (Includes: Trim, Oil
Pressure, Voltmeter & Water Temperature)
- SmartCraft System Speedometer (Includes: Air & Water
Temperature, Combined Fuel Level Range & GPS
Interface)
- SmartCraft System Tachometers (2) (Includes: Depth,
Engine Alarms/Hour Meters, Fuel Consumption/
Usage & Trim Level)
- Fuel Level

Steering, Power-Assisted w/ Isotta Vertice Tilt Wheel
Switch Panel w/ Illuminated Weatherproof Push Button
Switches
Tilt & Trim, Power

ELECTRICAL SYSTEMS:

Battery Switches
Breaker Panels, Waterproof Electronic Interface Modules
Fuse Block
Isolator, Galvanic
Main DC Distribution Hub
Mercathode
Panel, Main Distribution AC/DC w/Voltage & Current Meters
Shore Power- 30AMP 120V w/ 50' Cord

ENGINE ROOM:

Bilge Pump, 12V Automatic
Bilge Pump, 12V Automatic High-Water
Blowers, 12V Bilge
Fire Suppression System - Automatic w/Manual Pull
Insulated & Gel-Coated Engine Room
Lighting, 12V
Oil Filters - Remote

FUEL SYSTEM:

Evaporative Emissions Fuel System
Fuel Lines, USCG - Type A-1
Fuel Tank w/Anti-Siphon Valve & Mechanical Sending Unit

UNDERWATER GEAR:

Propellers, Stainless Steel
Variable Running Surface - Trim Tabs & Trim Indicators

WASTE SYSTEM:

Head System (VacuFlush®)
Holding Tank Level Indicator - MDP
Holding Tank w/Dockside Pump-Out (28 Gallon)
Sump Box w/Pump - Automatic

WATER SYSTEM:

Freshwater Washdown Spigot
Pressure Water System w/12V Pump & Filtration System
Shower, Transom - Hot & Cold
Water Heater, 120V (6 Gallon)
Water Inlet, Dockside
Water Manifold System
Water Tank (32 Gallon)

STANDARD PROPULSION

Twin MerCruiser® 4.5L MPI ECT* Bravo® III
w/DTS Sterndrives (T-250 php - 186 kW)
*Non-catalyzed engines available for select international
markets. Consult your local dealer for availability.

OPTIONS & ACCESSORIES

OPTIONAL PROPULSION

TWIN GASOLINE STERNDRIVES:

T-MerCruiser 6.2L MPI ECT* Bravo III w/DTS
(T-300 php - 224 kW)
T-MerCruiser 6.2L MPI ECT* Bravo III w/DTS
(T-350 php - 261 kW)

*Non-catalyzed engines available for select international
markets. Consult your local dealer for availability.

AXIUS® PROPULSION:

T-MerCruiser 4.5L MPI ECT* Bravo IIIx w/Axius
(T-250 php - 186 kW)
T-MerCruiser 6.2L MPI ECT* Bravo IIIx w/Axius
(T-300 php - 224 kW)
T-MerCruiser 6.2L MPI ECT* Bravo IIIx w/Axius
(T-350 php - 261 kW)

AXIUS® W/SEACORE PROPULSION:

T-MerCruiser 6.2L MPI ECT* SeaCore® Bravo IIIx w/Axius
(T-300 php - 224 kW)
T-MerCruiser 6.2L MPI ECT* SeaCore® Bravo IIIx w/Axius
(T-350 php - 261 kW)
Axius Propulsion System Includes Axius Control Joystick,
SmartCraft Digital Throttle & Shift & SmartCraft
VesselView Display

*Non-catalyzed engines available for select international
markets. Consult your local dealer for availability.

TWIN DIESEL STERNDRIVES:

T-Mercury® 3.0 TDI Diesel Bravo IIIx w/ DTS
(T-260 hp - 193 kW)

SUNDANCER® 320

EXTERIOR COLOR

Bottom Paint - White Hull Only
Gel Coat Full Hull Color

UPHOLSTERY, INTERIOR, SEATING & FLOORING

Bow Table w/Dedicated Storage
Dune Cockpit Color
Fiberglass Cockpit Table w/Teak Overlay
Infinity Woven Vinyl Cockpit Flooring
Interior - Driftwood
Ivory Cockpit Color
Prestige Cherry Interior Package A
SeaDek Swim Platform Matting (Matches Interior Color)
Teak Flooring - Swim Platform
Teak Flooring for Bow, Cockpit & Swim Platform
Transom Sun Pad Seating
Upholstery, Seating & Layout

HARDTOP, TOWERS & CANVAS

Cockpit Cover
Fiberglass Hardtop w/ Opening Canvas & Extended Sunshade
Fiberglass Hardtop w/Lights & Anchor Light
Hardtop w/ Extended Sunshade
Hardtop w/ Opening Canvas
Sunshade, Bow Seating

ELECTRONICS

4G Radar
Flat Screen TV w/ DVD Player - V-Berth
Flat Screen TV w/DVD Player - Mid Cabin
Marine Weather
Premier Audio Upgrade - Combined Cabin & Cockpit (Includes:
Amp & Subwoofer, Upgraded Speakers & Transom Stereo Remote)
Simrad G09 Dual (9") Touchscreen Displays W/ Mercury
Vessel View Link Data
SiriusXM Satellite Receiver (N/A outside North America)
VHF Radio w/ Antenna

ADDITIONAL OPTIONS

220 V / 50 Cycle Electrical System
Active Trim by Mercury Marine
Air Conditioning / Heating, Cabin (120v/60)
Air Conditioning / Heating, Cabin (220v/50)
Air Conditioning/Heating - Cockpit & Cabin, 120v/60
Air Conditioning/Heating - Cockpit & Cabin, 220v/50
All Chain Windlass w/Galvanized Anchor
Battery Charger 120v/60 to 12v
Battery Charger 220v/50 to 12v
Blue LED Lighting Package
Bow Rail, Split
Bow Thruster
C E Option Group
Cockpit Built In Grill - 120v/60
Cockpit Built In Grill- 220v/50
Cockpit Refrigerator Dual Volt (120v/60-12v)
Cockpit Refrigerator Dual Volt (220v/50-12v)

Electric Submersible Swim Platform
Fender Clip System - Quick Connect
Flagpole w/ Base & US Flag
Generator (120v/60) - Diesel
Generator (120v/60) - Gas
Generator (220v/50) - Diesel
Generator (220v/50) - Gas
Gray Water System
Inverter - 12v To 120v/60 Cycle
Inverter - 12v To 220v/50 Cycle
Macerator w/ Seacock Interlock System
Opening Portlights
Remote Controlled 5" Spotlight
Rope/Chain Windlass
Shore Power - Dual 16amp 220v/50 w/Cord
Shore Power - Dual 30amp 120v/60 w/Cord
Stainless Steel Anchor -(Only Available W/ Windlass Option)
Thru Hull Under Water LED Lights
VacuFlush Head System w/ Direct Overboard Discharge (Int'l)
White LED Lighting Package

NOTE: Some features and options may not be available when a boat is built for regions outside North America and/ or has CE Certification. Boats ordered with 220V/50 cycle electrical systems will have the appropriate appliances in the corresponding voltage.



DECK / COCKPIT LAYOUT
(Shown w/ Optional Equipment)

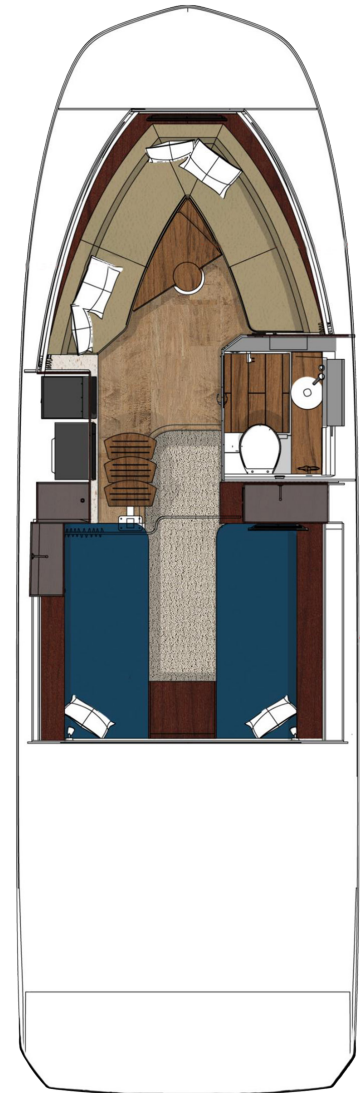

CABIN LAYOUT

SUNDANCER® 320

Some find it hard to disconnect, but it's easy when a Sea Ray Sundancer is your escape plan. Cast off and chase relaxation with the mobile pampering that a Sea Ray sport cruiser offers. Social zones in the cockpit, on the bow or swim platform, in the salon or mid-cabin—all around the boat—help your whole crew settle into conversation and ease into the relief of letting go. Leave the everyday behind for the better day ahead.

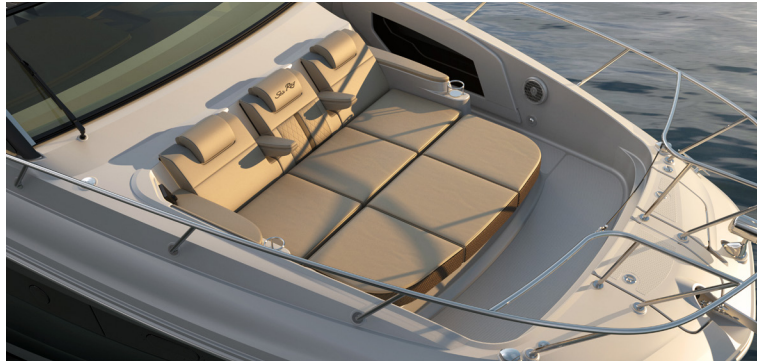

The traditional bow sunpad has evolved into a much more robust lounge seating area, inviting a group to socialize and enjoy the view. The best part? The bow can be fully enjoyed while underway. Actuated headrests, armrests and seats allow users to adjust for perfect comfort, with a stowable table conveniently in reach. An optional bow sunshade can extend over the area to offer protection from the sun while at rest.



The cockpit affords effortless, versatile enjoyment of the water, with a natural flow from the helm all the way through the transom and onto the integrated swim platform. A reversible helm companion seat converts to face aft, facilitating conversation with the rest of the cockpit. A well-equipped standard wetbar includes a sink and storage, and offers a refrigerator and grill as options.



For ducking out of the elements or making an overnight or weekend-long getaway, the Sundancer 320 features a beautifully designed cabin with sleeping accommodations for 4. In the aft berth, two sliding twin beds can be combined to form a queen bed.



In the forward Salon / V-berth, a stylish wood table converts via filler cushion to form a comfortable full-sized bed. A deluxe head, gourmet-ready galley with extending countertops, flatscreen TV and generous storage round out this inviting space.



09222017